

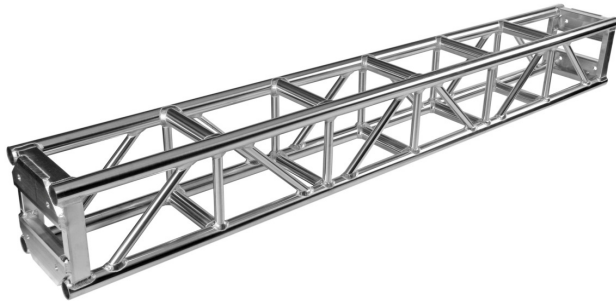

### PLATED FEATURES

Highly Polished Aluminum Tubing  
 1.9" OD 6061-T6 Aluminum Tube Schd #40  
 0.145" Wall Thickness  
 1.05" OD Aluminum Bracing  
 Fabricated By Certified Welders  
 Custom Lengths & Corners Available  
 Powder Coating Available



Applied Electronics Heavy Duty 12" Box Truss is manufactured with schedule 40, 1.9" OD x 0.145" wall main chords and 1.05" OD x 0.125" wall diagonal bracing. All components are 6061-T6 aluminum tubing and 5/8" grade 8 bolts are included for assembly of the truss elements. Heavy Duty 12" truss, combined with the matching corner blocks, can be used to construct a grid.

### PLATED ORDERING INFORMATION

Item No.	Dimensions	Weight
9-12-120	12" x 12" x 10'	62 lbs.
9-12-096	12" x 12" x 8'	47 lbs.
9-12-060	12" x 12" x 5'	36 lbs.
9-12-030	12" x 12" x 2.5'	24 lbs.
9-12-004	4-Way Corner	20 lbs.
9-12-005	5-Way Corner	25 lbs.
9-12-006	6-Way Corner	29 lbs.

### SPIGOTED FEATURES

Highly Polished Aluminum Tubing  
 1.9" OD 6061-T6 Aluminum Tube Schd #80  
 0.200" Wall Thickness  
 1.05" OD Aluminum Bracing  
 Steel Spigots and Pins  
 Fabricated By Certified Welders  
 Custom Lengths & Corners Available  
 Powder Coating Available

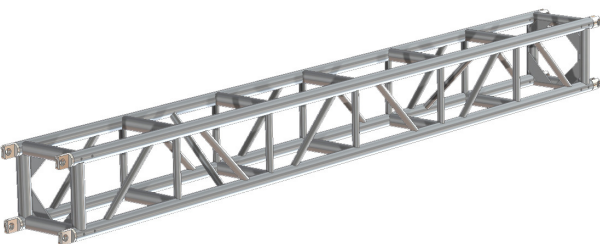

#### PLATED ALLOWABLE LOAD DATA

SPAN (ft.)	UNIFORMLY DISTRIBUTED LOAD			CENTER POINT LOAD	
	LOAD (#/ft.)	LOAD (#)	MAX. DEFL. (in.)	LOAD (#)	MAX. DEFL. (in.)
10	380	3800	0.250	1600	0.202
20	114	2280	0.940	900	0.660
30	44	1320	1.730	770	1.630
40	20	800	2.781	420	2.312

Connection: 5/8" Dia. x 2" Grade 8 Bolts

Weight Load Certified By Structural Engineer **\*\*SINGLE USE\*\***

### SPIGOTED ORDERING INFORMATION

Item No.	Dimensions	Weight
13-11-120	12" x 12" x 10'	81 lbs.
13-11-096	12" x 12" x 8'	65 lbs.
13-11-060	12" x 12" x 5'	39 lbs.
13-11-030	12" x 12" x 2.5'	30 lbs.
13-11-002	2-Way Corner	30 lbs.
13-11-004	4-Way Corner	35 lbs.
13-11-005	5-Way Corner	45 lbs.

#### SPIGOTED ALLOWABLE LOAD DATA

SPAN (ft.)	UNIFORMLY DISTRIBUTED LOAD			CENTER POINT LOAD	
	LOAD (#/ft.)	LOAD (#)	MAX. DEFL. (in.)	LOAD (#)	MAX. DEFL. (in.)
10	355	3550	0.167	2500	0.192
20	165	3300	0.691	1800	0.641
30	84	2520	1.688	1275	1.361
40	44	1760	3.204	875	2.466

Connection: Steel Spigots and 3/4" x 2-1/2" Clevis Pins

Weight Load Certified By Structural Engineer **\*\*SINGLE USE\*\***