

Ultra Arc[®] Titan

Long Throw Followspot



DESCRIPTION

The **Ultra Arc Titan** is the latest addition to the Ultra Arc family of high intensity followspots from Phoebus Manufacturing. Constructed of the highest quality components, the Titan continues the Ultra Arc tradition of dependability and insures years of safe reliable service.

The Titan features a 1200 watt single ended HMI lamp with a rated life of 750 hours and a color temperature of 5600° Kelvin.

Designed for throws between 100 feet and 300 feet the Titan's precision lens system and a specially designed reflector produce maximum light output while maintaining a flat even field. A lightweight magnetic ballast draws less than 15 amps from standard 120 volt 50/60 Hz AC power.

Options include a rugged, lightweight road case designed specially for the Titan, a 15 lb. solid state power supply, 220/240 volt 50 Hz operation and a hanging yoke.

Ideal for today's live event venues the Titan advances the Ultra Arc line of followspots to a new level of competitiveness and continues the legacy of quality, dependability and affordability. Ease of handling and quality construction insure that the Ultra Arc line of followspots will cover any application from the smallest schools, clubs and churches to full-scale entertainment facilities.

FEATURES

- throws from 100-300 feet
- 4:1 zoom range
- draws less than 15 amps
- 750 hour lamp life
- dowsers, iris and clipper
- built-in, six-color automatic color changer
- steep 70° downward tilt and 60° upward tilt
- full 360° horizontal sweep
- efficient forced air cooling
- superb lumen maintenance hour meter
- lightweight aluminum housing, classis, bulkheads and components
- magnetic power supply
- sturdy 4-point collapsible base
- quiet and cool running
- easy to transport – easy to operate – easy to afford
- Rear Access Door-for quick and easy light field adjustments.

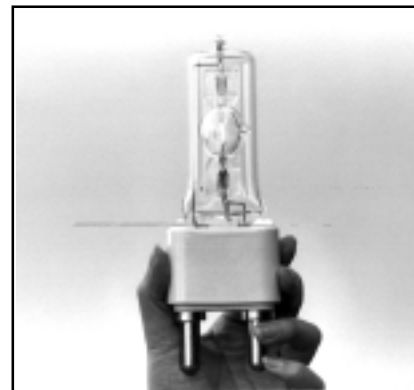

1200WSE lamp



PHOEBUS MANUFACTURING

A division of The Phoebus Company, Inc.
2800 Third Street
San Francisco, CA 94107
Tel. 415 550 1177
Fax. 415 550 2655
www.phoebus.com

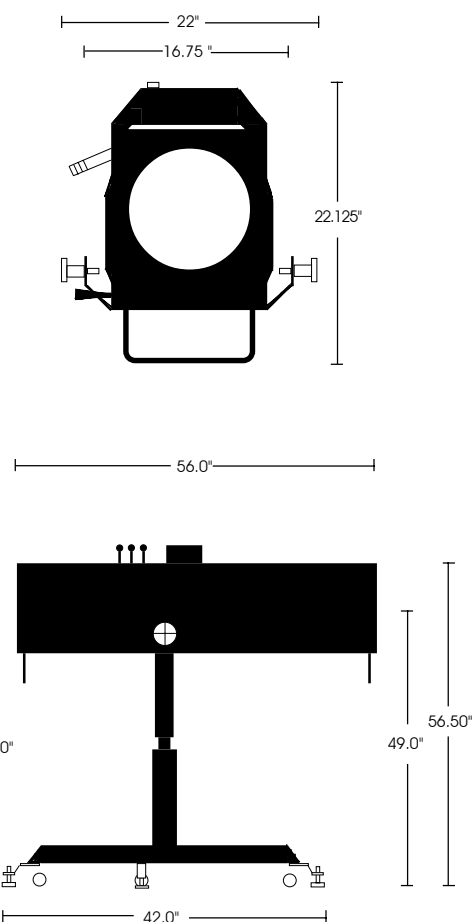
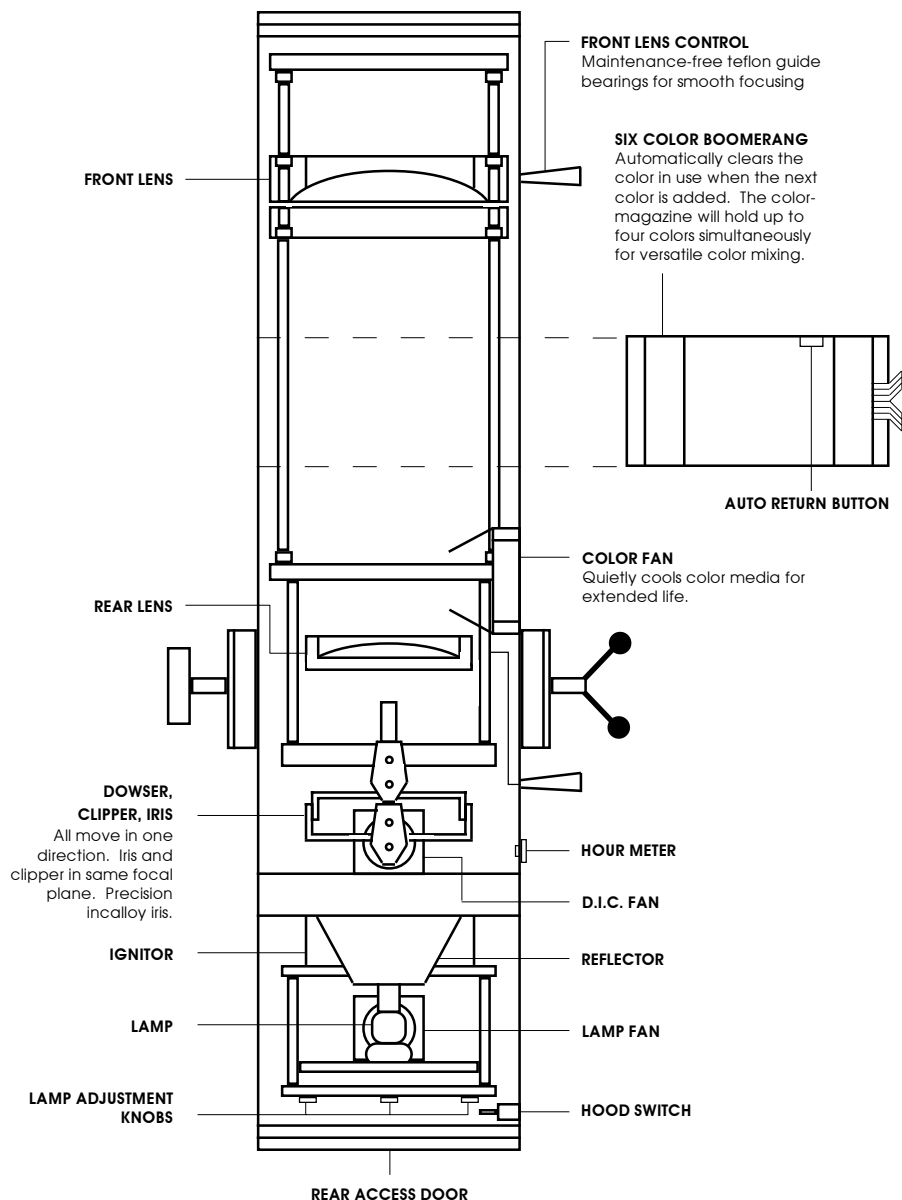

SPECIFICATIONS

Head Length	56.0"
Overall Head Height	22.2"
Overall Height w/Base	56.5"
Height of Pivot Point	45.0"
Floor to Beam Center	49.0"
Base Width	42.0"
Front Clearance Radius for:	
Vertical Movement	36.0"
Horizontal Movement	36.0"
Rear Clearance Radius for:	
Vertical Movement	25.0"
Horizontal Movement	23.5"
Maximum Height at Rear with Downward Tilt	70.0"
Maximum Height at Front with Upward Tilt	81.0"
Maximum Downward Tilt From Horizontal	70°
Maximum Upward Tilt From Horizontal	60°
Horizontal Sweep	360°
Lamp	HMI 1200
Watt	
Power Requirement	15A 120VAC
Head Weight	93 lbs
Ballast Weight	43 lbs
Base Weight	40 lbs
Cord Length	

Titan Long Throw Optical System Performance At Various Distances

Throw In Feet	Spot			Flood		
	Min Diam	Max Diam	Footcandles	Min Diam	Max Diam	Footcandles
50	5"	30"	3000	1'	8'	650
75	8"	4'	1300	1' 6"	12'	300
100	10"	5'	750	2'	16'	160
150	15"	7' 6"	325	3'	24'	70
200	1' 9"	10'	180	4'	32'	40
300	2' 7"	15'	80	6'	48'	18

Note: Measurements were completed with a flat field setting and an Osram 1200W/SE lamp.